

Jockey Club Duke of Edinburgh Training Camp - Price List

A) Camp Fee

Day & Evening Camp	Type	Time	*Special Rate	Full Rate
Year Round	Day Camp (Max: 200 persons)	09:00-16:00	\$35/pax	\$45/pax
	Evening Camp (Max: 200 persons)	14:00-21:00	\$35/pax	\$45/pax
Overnight Camp	Room Type	Quantity	*Special Rate/night	Full Rate/night
Year Round Residential camp (Check-in Time : Check in day 15:00; Check-out Time : Check out day 13:00)	2 Persons	2 rooms	\$358/room	\$452/room
	3 Persons	3 rooms	\$537/room	\$678/room
	4 Persons	3 rooms	\$472/room	\$588/room
	18 Persons	2 dormitories	\$2,124/dormitory	\$2,646/ dormitory
	20 Persons	1 dormitory	\$2,360/ dormitory	\$2,940/ dormitory
	22 Persons	1 dormitory	\$2,596/ dormitory	\$3,234/ dormitory
	24 Persons	2 dormitories	\$2,832/ dormitory	\$3,528/ dormitory
	26 Persons	1 dormitory	\$3,068/ dormitory	\$3,822/ dormitory
	Wild Camp		\$45/pax	\$60/pax
Full Camp (No applications from other groups will be accepted during the camp)	Includes All Residential rooms (Excludes venue and activity)		\$31,000/night	\$37,900/night

- Notes :
- *Special Rate applies to Schools, Non-Governmental Organisations, National Sports Associations, Youth & Uniformed Groups, Government Department and Groups that are exempted from tax under section 88 of Inland Revenue Ordinance of Hong Kong.
 - The applicant must be a Hong Kong resident over 18 years of age with valid identity document and accompanying his/her campers throughout the camping period.
 - Except for 2-persons room, all rooms are of bunk beds setting. Please note that there are no extra beds available in the camp.
 - Please note that 3-person rooms are of bunk beds setting, with the lower decks being double beds.
 - Please return the key to our staff before noon on the check-out day. An administrative fee of \$200/room per hour will be charged for the overtime, while less than an hour also counts as an hour.
 - The minimum number of people for booking is 8 people for Residential camp and 15 people for Wild camp, Day camp and Evening camp. Everyone in the camp must apply for a camp/residential space, including children aged 3 or below who must be accompanied by an adult.
 - Camping equipment is not included in the camping fees. Campers are required to bring their own equipment.
 - The Applicant should book the Catering, Facilities and Activities 2 months prior to the camping period. Any overdue booking and submission will not be entertained by the Camp.
 - Jockey Club Duke of Edinburgh Training Camp reserves the final right to add, delete, or alter the above regulations without prior notice to campers.

B) Catering Fee (Minimum 8 persons per meal)

Breakfast

Overnight Camp: 0800-0845 \$30/pax

Lunch

Overnight Camp: 1200-1245 Day Camp :1315-1400 \$50/pax

Dinner

Overnight Camp: 1800-1845 Evening Camp: 1915-2000 \$50/pax

- Notes :
- 1) No outside food or beverages will be allowed. Cooking or lighting is strictly prohibited in the camp, except when conducting activities offered by our Camp such as the Wild Cook activity or the Cookery Classes.
 - 2) The restaurant is only for campers who have reserved meals (except children under the age of 3, not occupying a seat).
 - 3) Due to food hygiene issues, all ordered foods will not be available for take-out or refunds. Campers must be punctual for every meal. Latecomers will not be served, and no refund will be arranged.
 - 4) Please enjoy your meal within the meal period and leave the dining venue at the specific time. Proper cleaning will be performed at the dining venue after meal period.

C) Venue Fee

Venue	Area	Number of Seats	Fee	Facilities & Equipment
Hall 1	~260 sq.m	~200 persons	\$420/hours	Stage, 200 chairs, 12 tables, 4 wireless microphones, 2 portable whiteboards, 2 projectors, and 2 screens.
Hall 2	~260 sq.m	~200 persons	\$350/hours	200 chairs, 12 tables, 2 wireless microphones, 2 portable whiteboards, projector and screen.
Hub 2	~100 sq.m	~80 persons	\$140/hours	80 chairs, 10 tables, 2 wireless microphones, portable whiteboards, projector and screen
Hub 3	~69 sq.m	~40 persons	\$70/hours	40 chairs, 6 tables, 2 wireless microphones, portable whiteboards, , <i>Portable projector and screen*</i> ,

- Notes :
- 1) The venue rental fee includes air-conditioning and basic audio equipment (Wireless microphone x 2 nos).
 - 2) Each hiring period will be 1-hour minimum. Overtime usage will be charged at hourly rates with 1-hour minimum.
 - 3) The applicant(s) is responsible for reinstating the equipment and facilities to its original condition immediately after use.
 - 4) The applicant(s) should only use the provided or rented equipment and facilities in the booked venue(s). Applicants are responsible for cleaning and returning used equipment and facilities after use.
 - 5) *The applicant should book the Portable projector and screen in advance.
 - 6) Campers are not allowed to occupy common area or corridors for activities (including but not limited to the turf, open space near the driveway, corridors, spaces outside any activity venues, and other public spaces). The Camp reserves the right to terminate such activities immediately.

D) Activity Fee						
Activities	Opening Hour	Duration	No. of participants	Fee/Session	Age Restriction	
HADO AR Dodgeball (6 games per hour)	09:00-21:00	1 hour	10 persons	\$1,200		
RoboMaster Experience (4 sets of gear)	09:00-21:00	1 hour	8 persons	\$800	6 years old or above. Each participant under 6 years old must be accompanied by an adult	
Drone Experience (4 sets of gear)	09:00-21:00	1 hour	8 persons	\$800		
VR Experience (4 sets of gear)	09:00-21:00	1 hour	8 persons	\$800		
Cookery Classes	09:00-11:00/ 15:00-17:00	2 hours	8 persons	\$800		
Tie-dye Workshop	09:00-21:00	1 hour	8 persons	\$800	12 years old or above	
Mölkky (1 set of gear)	09:00-21:00	1 hour	8 persons	\$400		
Floor Curling (1 set of gear)	09:00-21:00	1 hour	12 persons	\$700		
Recreational Rope Course	09:00-17:00	1 hour	12 persons	\$300		
Sport Climbing (Single route)	09:00-17:00	1 hour	8 persons	\$500	8 years old or above	
Abseiling - High Wall (Single route)	09:00-17:00	1 hour	8 persons	\$500		
Abseiling - Adventure Park (Two routes)	09:00-17:00	2 hour	20 persons	\$1,700	14 years old or above	
Archery Combat (10 sets of gear)	09:00-21:00	2 hours	20 persons	\$1,900		
Semi-indoor Challenge Course (Single course)	09:00-21:00	2 hours	20 persons	\$1,700		
Adventure Park – Level 1 (Single route, 3 courses)	09:00-17:00	2 hours	20 persons	\$1,700		
Adventure Park – Level 2 (Single route, 3 courses)	09:00-17:00	2 hours	12 persons	\$1,700	14 years old or above	
High Rope Course (Single course)	09:00-17:00	2 hours	15 persons	\$1,700		

- Notes :
- 1) Coaching, venue rental and equipment costs are included in the activity fees.
 - 2) The charges do not include any debriefing session and it is only available in Cantonese. Quotation can be provided if extra service is needed.
 - 3) Activities briefing will be conducted one time only. Due to safety concerns, participants are not allowed to join any ongoing activities. During the rope course activities, participants must wear personal protective equipment provided by the camp. Also, participants will take turns to wear personal protective equipment.
 - 4) Due to safety and equipment concerns, there are age restrictions for camp activities. Participants must be at a certain age to participate. The camp has the right to refuse activities to participants who fail to meet the activity requirements .
 - 5) An adult must be present to accompany each participant under 6 years old. If all participants are under 18 years old, at least 1 adult are required to be present during the activity. If all participants are under 12 years old, at least 2 adults are required to be present during the activity.

HADO AR Dodgeball



RoboMaster Experience



Drone Experience



VR Experience



Cookery Classes



Tie-dye Experience



Recreational Rope Course



Sport Climbing



Abseiling - High Wall



Abseiling - Adventure Park



Archery Combat



Mölkky



Floor Curling



Adventure Park



High Rope Course - Trapeze



High Rope Course - High Balance



Semi-indoor Challenge Course

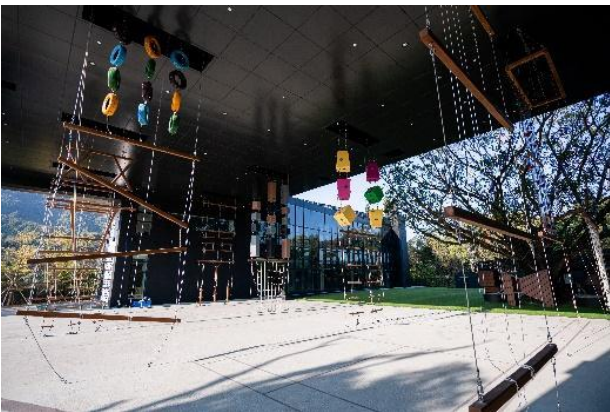

Course 1



Course 2

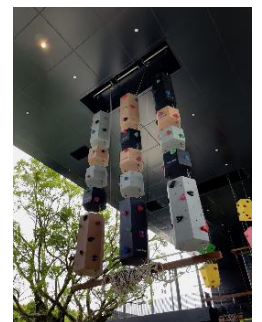

Course 3

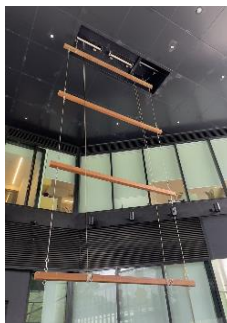

Course 4

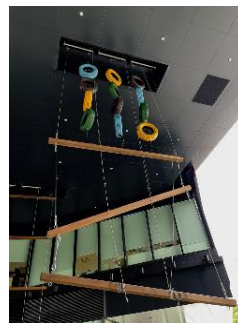

Course 5



Course 6